

INTRODUCTION

PRODUCT FEATURES

- It is produced by one-piece injection molding process, without welding points and side leakage.
- It has excellent chemical corrosion resistance, acid and alkali resistance, high temperature and high pressure resistance, wear resistance, and aging resistance.
- The arc structure fits tightly against the filter basket seal ring, improving the sealing performance between the filter basket and the housing.
- Easier to install and replace, with rotating bolt cover type and screw cover type.

INCEF--1 A---P---R---K

- 1 2 3 4 5 6

[Model-1]: INCE: Company F: One-piece filter housing

[Filter bag size-2]: 1: $\phi 7'' \times 17'' L (\phi 180 \times 430 \text{mm})$, 2: $\phi 7'' \times 32'' L (\phi 180 \times 810 \text{mm})$,
4: $\phi 4'' \times 15'' L (\phi 105 \times 380 \text{mm})$, 5: $\phi 6'' \times 20'' L (\phi 150 \times 510 \text{mm})$,
6: $\phi 7'' \times 22'' L (\phi 180 \times 560 \text{mm})$

[Upper cover style-3]: A: Screw top cover, B: Lifting ring gland,
AX: Screw top cover, the water inlet and outlet are union type.

[Main material-4]: P:PPH, V:PVDF

[Upper cover joint-5]: D: Internal tooth PT1/2 (with plug, without pressure gauge),
R: External tooth PT1/2 connector (with pressure gauge),
E: Exhaust valve (with pressure gauge)

[Protection switch-6]: None: Without protection switch, K: Install protection switch (micro switch type)

PRODUCT PARTS DISPLAY TABLE

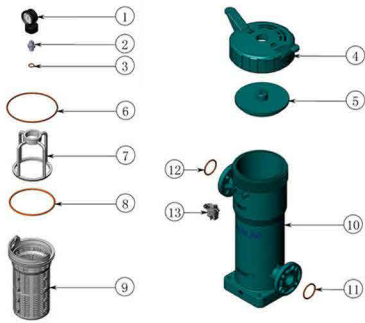

Components	Main Material
1 Pressure gauge	Please confirm the specifications when placing an order!
2 Pressure gauge joint	PP
3 O ring	FKM
4 upper cover	PPH
5 Inside the cover	PPH
6 Bucket O ring	FKM
7 Pressure ring	PPH
8 Basket O ring	FKM
9 Basket	PPH
10 Filter body	PPH
11 Filter outlet O ring	FKM
12 Filter inlet O ring	FKM
13 Protection switch	Please confirm your requirements when placing an order!

SINGLE BAG FILTER HOUSING PARAMETERS

Model	In-outlet (mm)	Filter Bag (mm)	Filter Area (m ²)	Housings capacity/weight (l/ kg)	Max Traffic (m ³ /h)	Operating Temp(°C)	Max Press (Mpa)
INCE-1A-P	50x50	180x430	0.25	20.3/15.3	20	90	0.8
INCE-2A-P	65x65	180x810	0.5	32/24.2	40	90	0.8
INCE-2B-P	65x65	180x810	0.5	32/24.2	40	90	0.8
INCE-4A-P	40x40	105x380	0.12	6.5/59	12	90	0.8
INCE-4AX-P	40x40	105x380	0.12	6.5/41	12	70	0.8
INCE-5A-P	50x50	150x510	0.3	2.8/10.8	22	90	0.8
INCE-6A-P	65x65	180x560	0.35	24/18	25	90	0.8

DIMENSIONS REFERENCE DIAGRAM

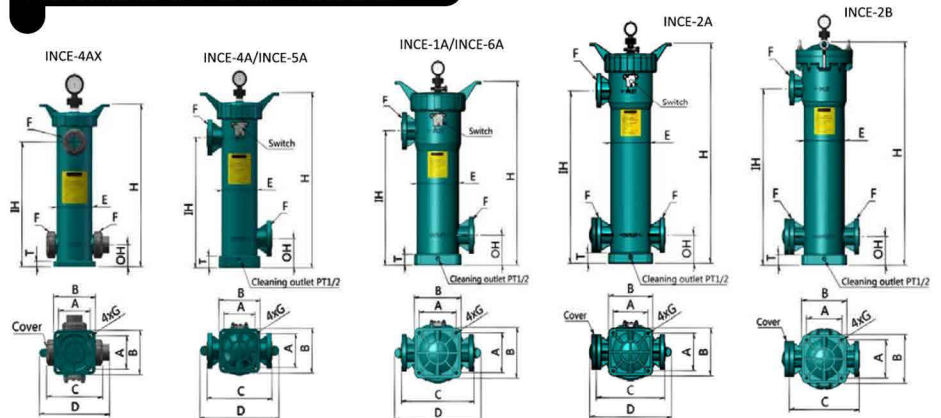

Model	A	B	C	D	E	F	G	T	IH	OH	H
INCEF-1A	200	255	394	470	$\phi 229$	2"	$\phi 19$	55	520	140	784
INCEF-2A	200	255	394	470	$\phi 229$	2-1/2"	$\phi 19$	55	520	150	1184
INCEF-2B	200	255	394		$\phi 229$	2-1/2"	$\phi 19$	55	930	150	1172
INCEF-4A	130	175	282	300	$\phi 148$	1-1/2"	$\phi 18$	45	450	130	628
INCEF-4AX	125	165	220	275	$\phi 140$	1-1/2"	$\phi 14$	20	455	80	592
INCEF-5A	156	206	324	396	$\phi 180$	2"	$\phi 18$	55	605	135	818
INCEF-6A	200	255	394	470	$\phi 229$	2-1/2"	$\phi 19$	55	677	150	938